

GroSens 2.2

Sensor Installation Guide



Installation

(in case of issues contact egro.support@grodan.com)

Step 1: Add GroSens Root Zone Sensor

Step 2: Add GroSens Climate Sensor

Step 3: Placement of GroSens Sensors

Step 4: Device Management

**Download the e-Gro
Companion app to continue**



Step 1: Add GroSens Root Zone Sensor

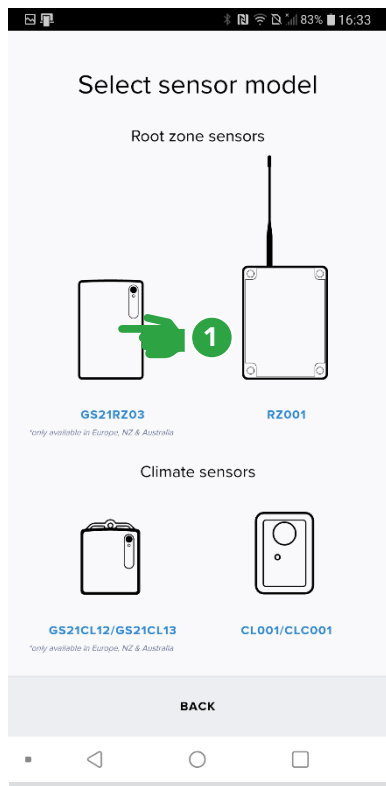
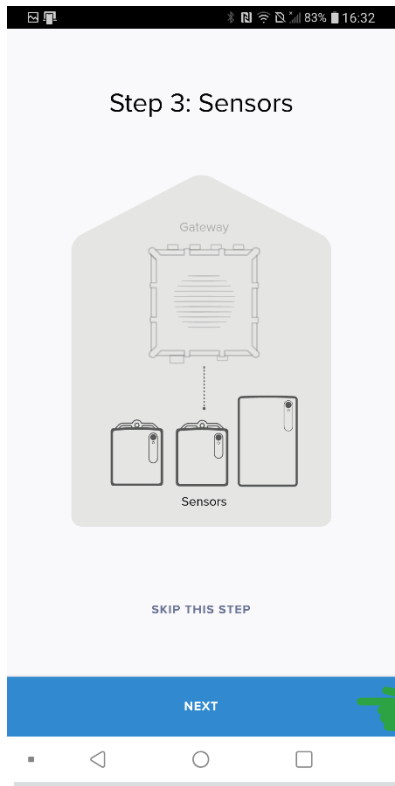

1 Select the GroSens sensor to install and follow the onscreen instructions. Additional details on the GroSens sensor installation, please refer to the GroSens installation manual

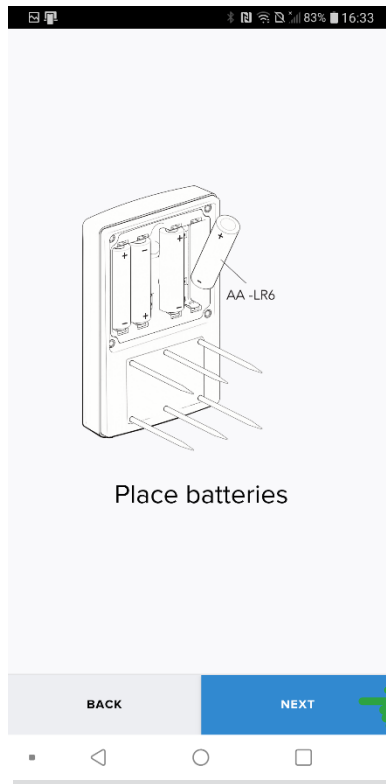
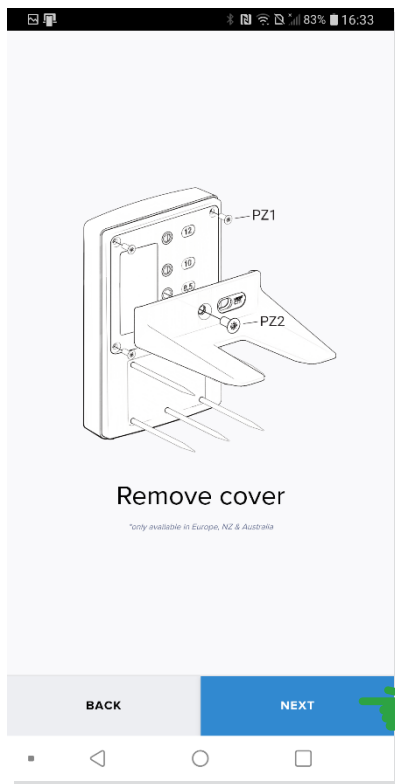

Step 1: Add GroSens Root Zone Sensor

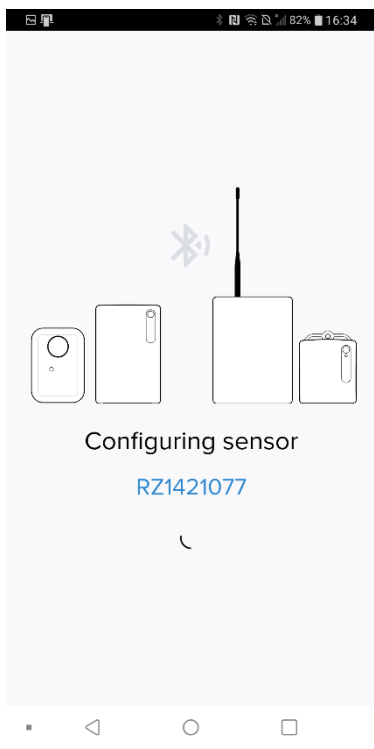
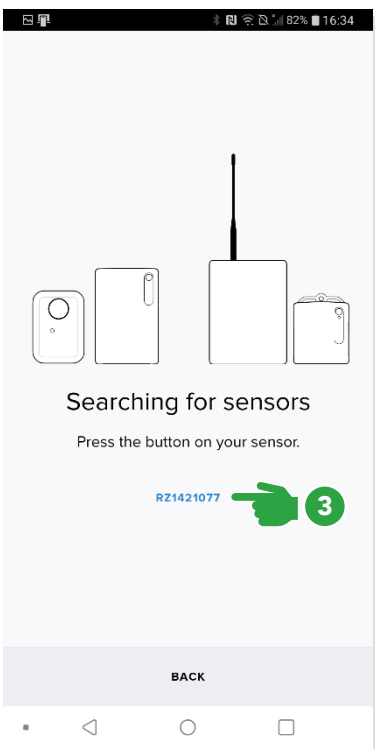
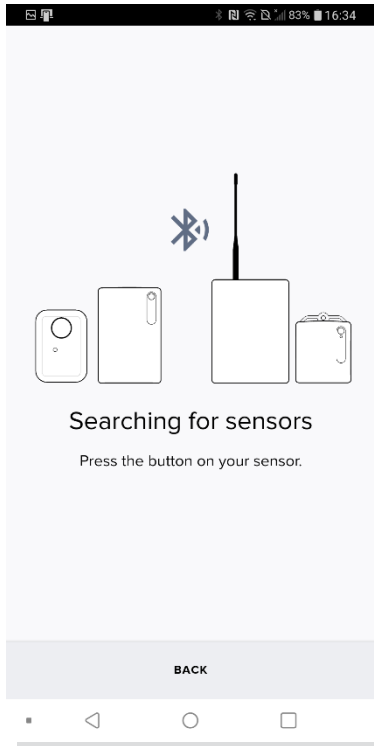
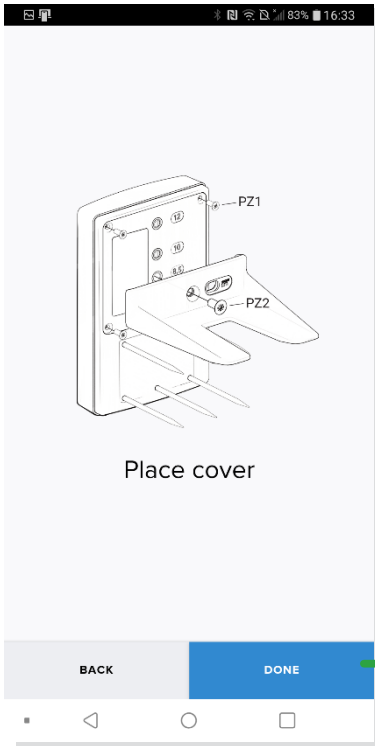

1 Press the button on the physical blue GroSens root zone sensor. The sensor number will appear in app

2 Light will start flashing

3 Press the sensor number of the sensor in the app to configure it.

Step 2: Add GroSens Climate Sensor

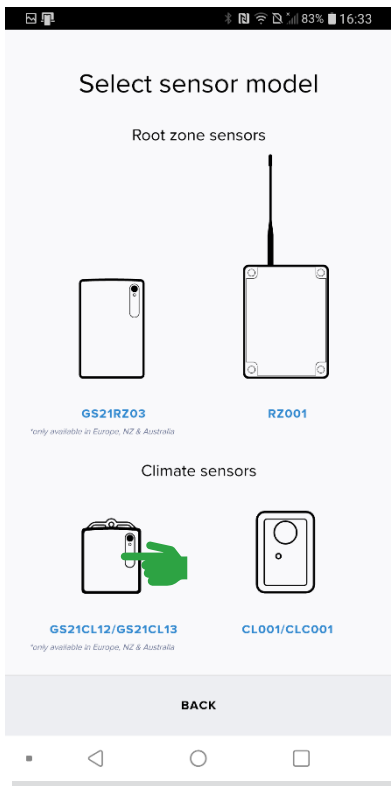

Step 2: Add GroSens Climate Sensor

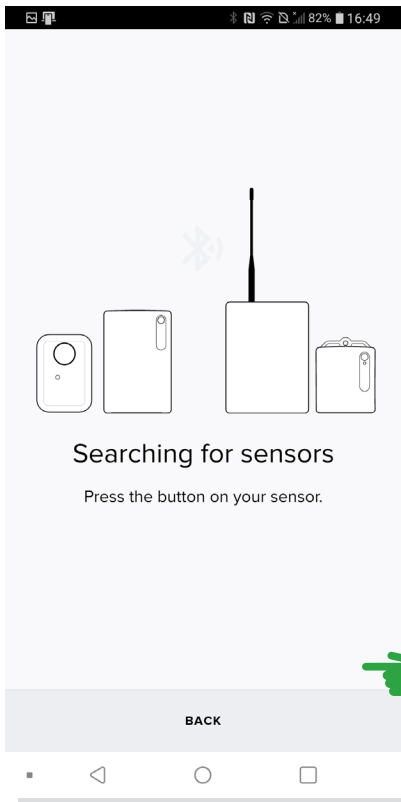

1 Press the button on the GroSens climate sensor. The sensor number will appear in app

2 Light will start flashing

3 GroSens climate sensor number will appear on the screen. Click on it.

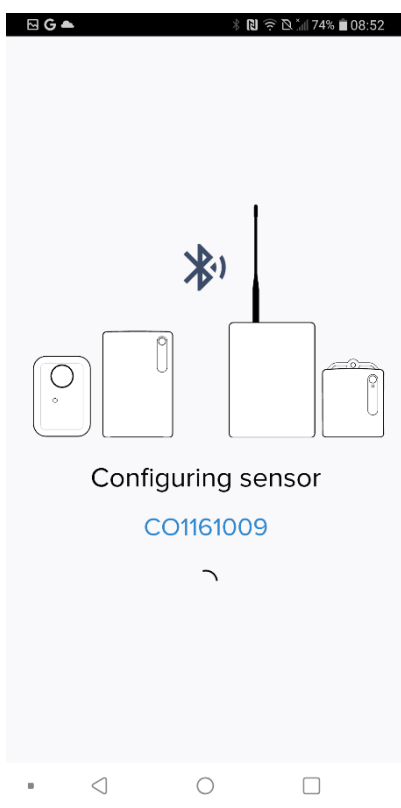
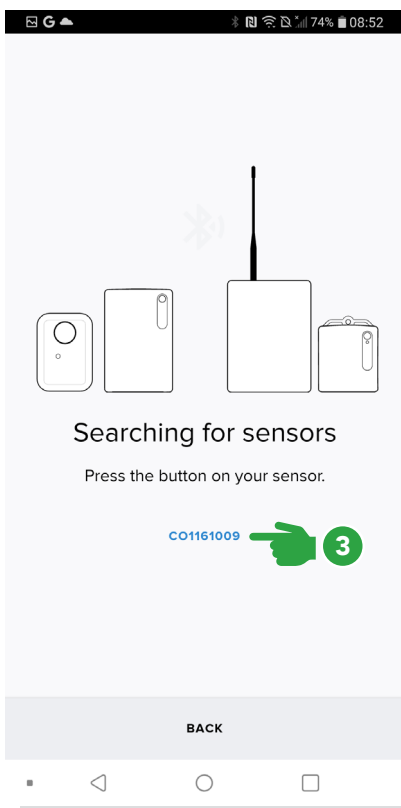

Step 3: Placement of GroSens Sensors

GroSens Rootzone sensor mounting

- Alignment plate mounted with single screw which can be changed easily
- Very clear slab height indicator on back of sensor

GroSens Rootzone placement

- GroSens Rootzone placement

GroSens Climate sensor mounting

- Hanging with wire or chain
- Pole mount using tie wrap
- Wall mount is possible but not recommended – air flow is reduced when placed against wall

GroSens Climate sensor placement considerations

- Place in similar position as the climate computer sensor is recommended
- Ensure sufficient air flow for accurate measurements
- Avoid direct sunlight to prevent impacts to temperature read-out (up to 5 deg C difference possible)

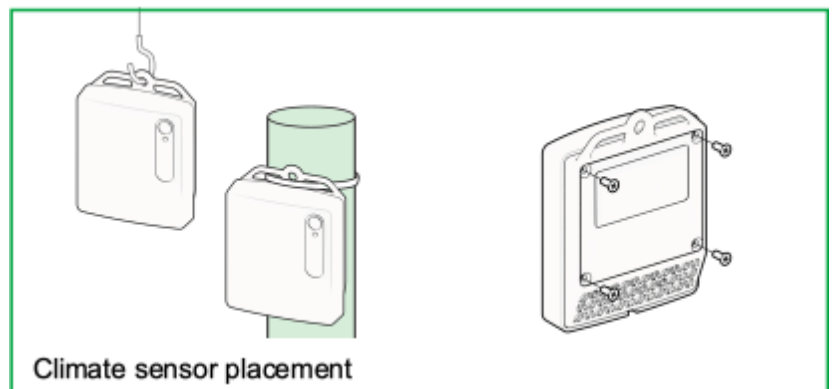
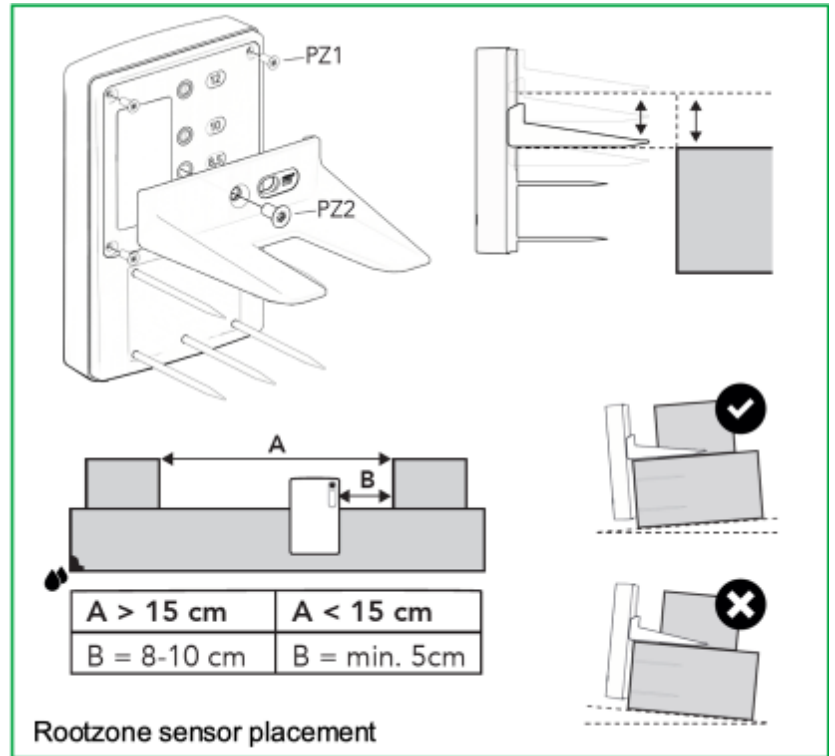

Step 4: Device management: adding hardware

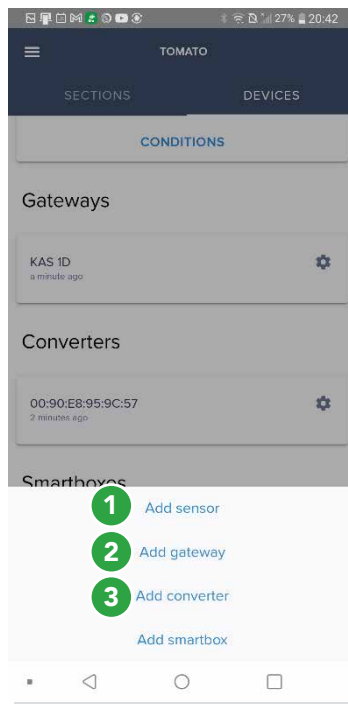
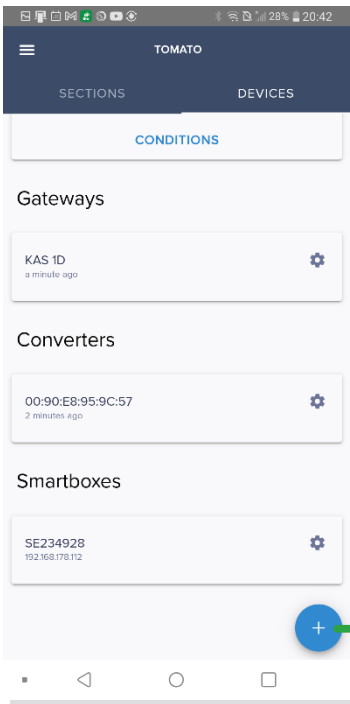

Processes are similar to installation.

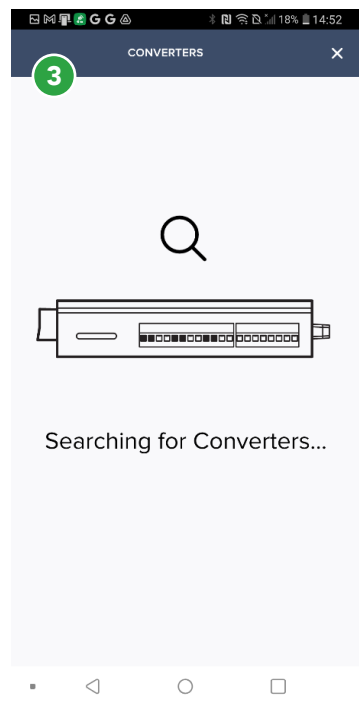
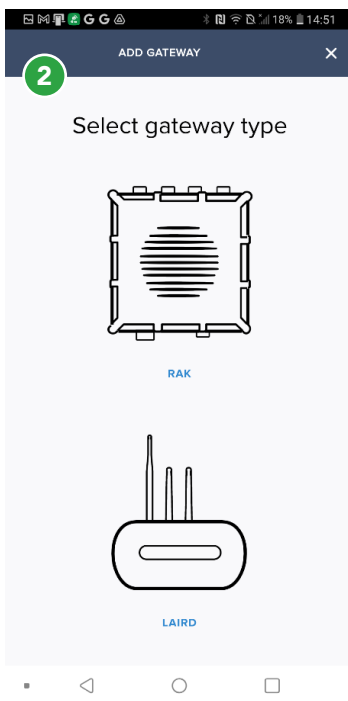
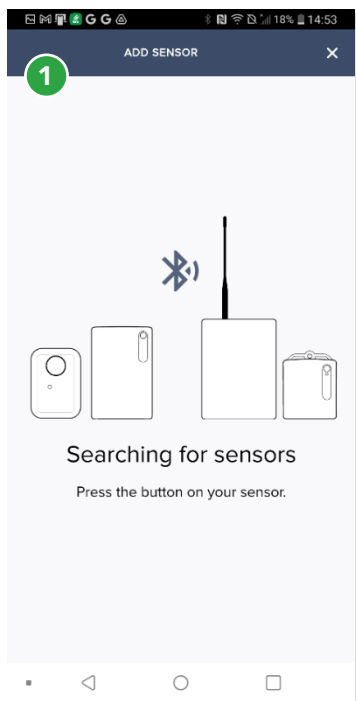

Step 4: Device management: sensor modifications via devices

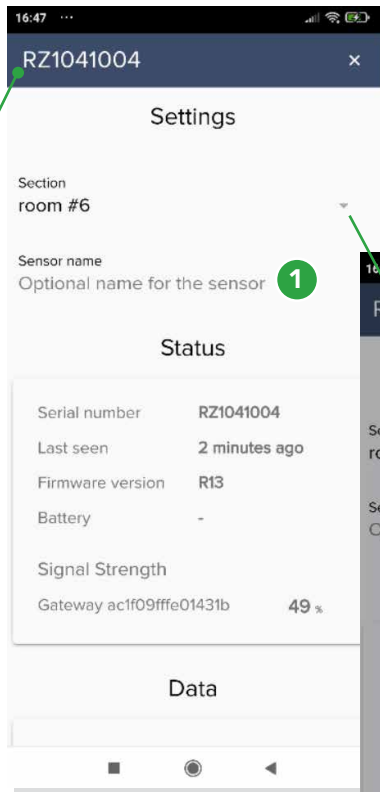
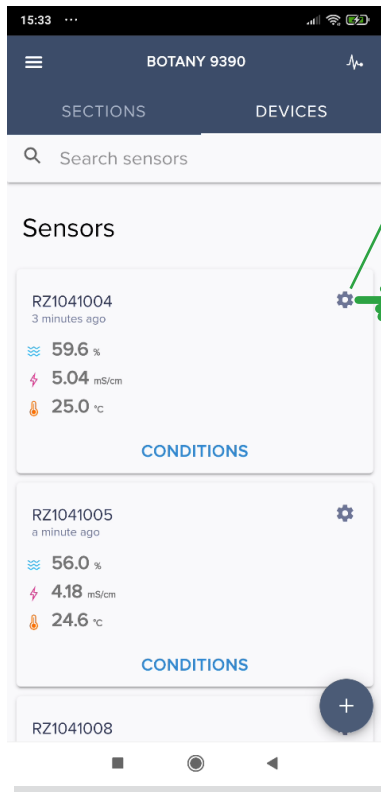

1 Advise to use this for location. For example: row 12, offset 4

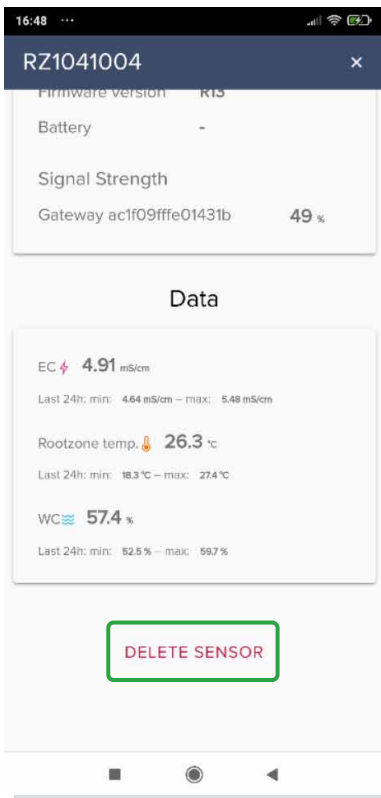
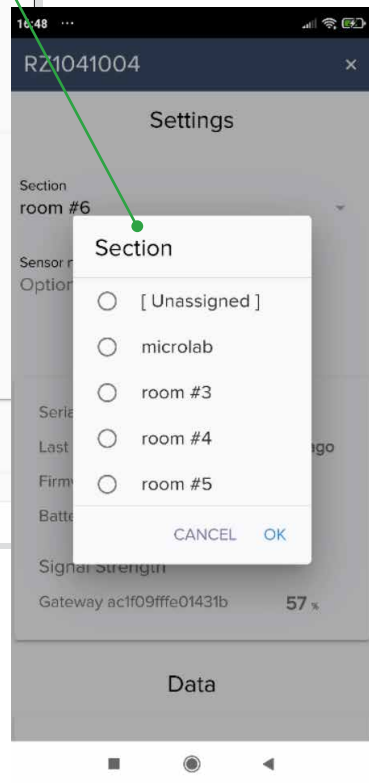

The Grodan Group supplies innovative, sustainable stone wool substrate solutions for the professional horticultural sector. Based on Precision Growing principles, these solutions are particularly applied to the cultivation of vegetables and flowers. In addition to its stone wool substrates, the Grodan Group also provides tailor-made advice and tools to support Precision Growing and thus facilitate the sustainable production of healthy, safe and tasty fresh produce for consumers.

Grodan, a division of ROCKWOOL

Industrieweg 15
Postbus 1160, 6040 KD Roermond
The Netherlands
T +31 (0)475 35 30 20
F +31 (0)475 35 37 16
info@grodan.com
www.grodan.com



ROCKWOOL® and Grodan® are registered trademarks of the ROCKWOOL Group.